



EXP-M302

2MP x30 Zoom HD-SDI Explosion Proof PTZ Camera

HD-SDI



EXP-M302

FEATURES

- 1/3" Panasonic New Generation CMOS
- Using progressive scan and Auto WDR
- x30 optical zoom and F1.6 aperture (optical zoom + digital zoom = x960).
- Defog : Defogging Video Image
- Auto ICR
- Up to 255 preset positions.
- Variable speed control for all motorized functions.
- Stainless Steel Construction
- Upright or Inverted Installation
- For Use in a Variety of Harsh and Hazardous Environments including Marine Environments
- Intergtrd Wiper
- 360° Continuous pan
- IP 66 SUS 316 housing

Block diagram

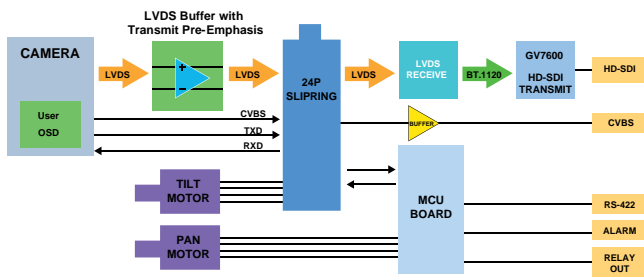

DIMENSIONS

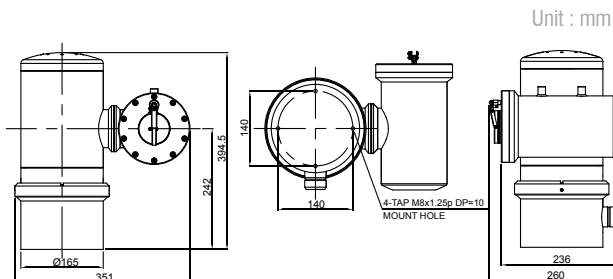

- ❖ Explosion Proof Camera
- ❖ SUS 316 Stainless

SPECIFICATIONS

MECHANICAL / ENVIRONMENTAL	
Pan	360° Continuous Pan 0.1° to 90°/sec (64 steps proportional to zoom)
Pan Preset Speed	380°/sec, ± 0.1° Accuracy
Tilt	0.1° to 90°/sec. (64 steps proportional to zoom)
Tilt Preset Speed	150°/sec, ± 0.01° Accuracy
Dimensions	236(Ø) x 325.9(H) mm – 166(Ø) dome
Construction	SUS 316
Ingress Protection	IP66 (Outdoor Housing)
Weight	Approximately 33Kg
Operating Temp	-40°C to 50°C (Fan&Heater power ON)
Storage Temp	-10°C to 50°C (14° F to 122° F)
Humidity	0% to 90% (non-condensing)
VIDEO	
Video Output	HD-SDI - 1 channel (1080i60,1080p30,720p60,1080i50, 1080p25, 720p50) CVBS -1 channel , IP Webserver (Option)
FUNCTIONS	
Preset	255 points less than 0.1° accuracy
Tour	8 programmable
Pattern	4 patterns for 240 second.
Flip	Digital ON/OFF
Scan	8 (programmable speed and diagonal scan)
Privacy Zone	Programmable up to 16
ID Address	Up to 255 selectable ID (Rotary switch)
Data Communication	RS-485 / RS-422
Protocol	Multiple protocol (PELCO-D/P, WONWOO)
Baud rate	2400, 4800, 9600, 19200, 38400, 57600 bps selectable
Alarm In	8 alarm
Alarm Out	2 relay out
Display	16 Area title
ELECTRICAL / USER CONNECTIONS	
Power	21 – 28VAC 60Hz / 50Hz(Power adaptor not included)
Camera	18.0W
Heater	33W or 62.7W, Fan Power Consumption: 3.4W
RS-422, 485	Dip Switch setting
RS-485, 422	RS-422, 485 + / - Optional Control Data
Alarm Inputs	8 Programmable
Relay Out	2 Dry Contact Output Rating: 2A @30VAC
CAMERA	
Image	1/3" Panasonic New Generation CMOS
Picture elements	1920 x 1080 pixels
Lens	x30 zoom f= 4.3 mm (WIDE)~129 mm (TELE), F1.6 to F5.0
Digital zoom	x32 (x960 with Digital zoom)
Angle of view (H)	Approx. 65.1° degrees (WIDE end), approx. 2.34° degrees (TELE end)
Min. working distance	100 mm (WIDE end), 800 mm(TELE end)
Sync system	Internal
Min. illumination	Color : 0.5 lux , BW : 0.1lux / Color DSS : 0.002 lux , BW DSS : 0.001 lux
Recommended illumination	100 to 100,000 lux
S/N ratio	50 dB (Weight ON)
Back light compensation	ON/OFF
Electronic shutter speed	1/30(25) ~ 1/60,000 sec
White balance	AUTO, ATW, Indoor, Outdoor, One Push WB, Manual WB, Outdoor Auto, Sodium Vapor
Gain	Auto/Manual (-3 dB to +28 dB, 16 steps)
Wide dynamic range	ON/OFF/AUTO
Noise reduction	ON/OFF (level 5 to 1 / OFF, 6 steps)
Color Enhancement	ON/OFF
Aperture control	16 steps